



## Discover the Luxurious Townhomes at Chatsworth Court An Elegant Living Experience at 626 Tolland Turnpike, Manchester

These newly constructed townhomes feature:

- Two-story foyer and open floor plan with over 1800 square feet of living space
- Hardwood floors on first floor
- Gourmet kitchen with an oversized center island, granite counters and GE appliances
- Large separate pantry closet, coat closet, powder room and access to a full basement
- Second floor primary with a full bathroom, shower, double sinks and private toilet room
- Dual oversized walk-in closets in primary bedroom
- Guest bedroom with large walkin closet
- Additional full bathroom with tub/shower plus separate laundry room
- Private garage
- Exterior deck and front porch

Prices starting at \$425,000.

**Don't miss the opportunity to make one of these exceptional townhomes your own.  
Experience the perfect blend of luxury, convenience, and modern living at an affordable price!**

Call 860-871-9055 or contact us at [Liz@nordicbuilders.com](mailto:Liz@nordicbuilders.com) for more information about Chatsworth!

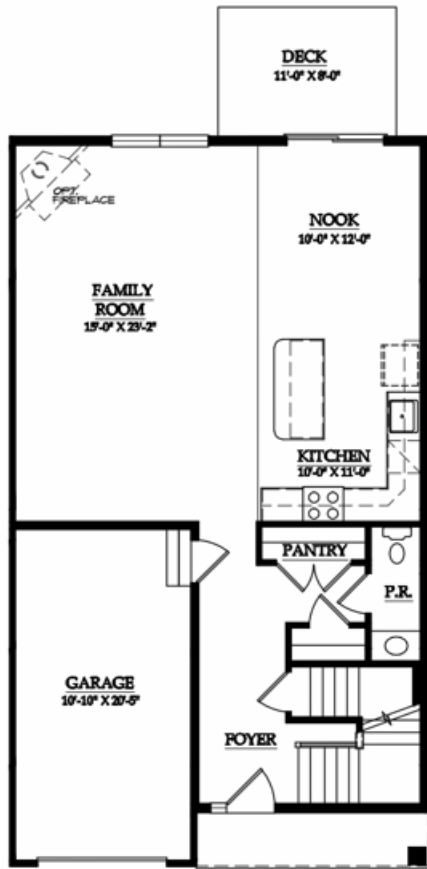

**FIRST FLOOR PLAN**

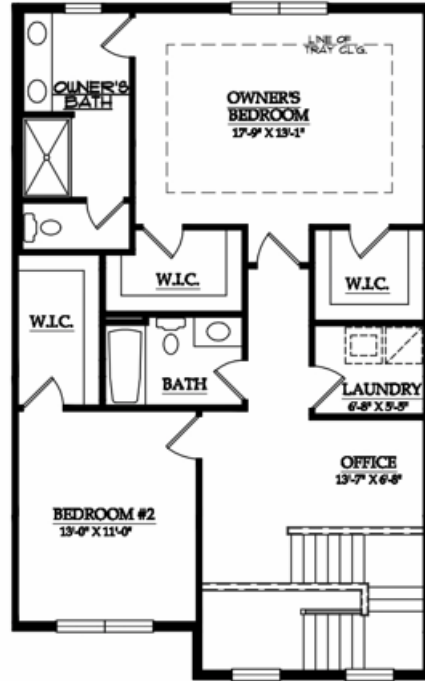

**SECOND FLOOR PLAN**